

FIELD INSTRUCTION EXB-210 8mm and EXB-218 4mm Libraries

Installing and Aligning the Cartridge Handling Mechanism (CHM) in the EXB-210 and EXB-218

Contents

About These Instructions	2
Contents of CHM Field Kit	2
1 Removing the Top and Side Cover (Vertical Model Only)	3
2 Removing the Service Access Cover	3
3 Removing the CHM	3
4 Removing the Bar Code Scanner (if necessary)	4
5 Installing the Bar Code Scanner on the New CHM	4
6 Installing and Aligning the CHM	5



Copyright

Copyright 1994 by Exabyte Corporation. All rights reserved. This item and the information contained herein are the property of Exabyte Corporation. No part of this document may be reproduced, transmitted, transcribed, stored in a retrieval system, or translated into any language or computer language in any form or by any means, electronic, mechanical, magnetic, optical, chemical, manual, or otherwise, without the express written permission of Exabyte Corporation, 1685 38th Street, Boulder, Colorado 80301.

Trademark Notices

EXABYTE is a registered trademark of Exabyte Corporation. All other brand and product names are trademarks or registered trademarks of their respective companies.

About These Instructions

These field instructions provide detailed instructions for installing and aligning a new cartridge handling mechanism (CHM) in the EXABYTE® EXB-210 8mm Library and EXB-218 4mm Library.

CAUTION

Use the alignment triangle when installing the CHM. Make sure you follow the procedure carefully; if you do not align the CHM with the triangle, the library will not operate properly.

This field instruction also provides steps for the other procedures required for installing a CHM; for detailed instructions on those procedures, refer to the maintenance manual for your library.

Make sure the maintenance environment for the library is free of conditions that could cause electrostatic discharge (ESD)

Contents of CHM Field Kit

The CHM field kit contains the following:

- Replacement CHM
- Alignment triangle
- These instructions

1 Removing the Top and Side Cover (Vertical Model Only)

If you have a vertical model of the library, remove the top cover by unscrewing the two screws on the upper back; remove the cover from the left side (viewed from the front) by removing the three screws on the top of the cover. Position the library horizontally on the work table.

2 Removing the Service Access Cover

To remove the service access cover, remove the four screws and pull up on the handle.

3 Removing the CHM

To remove the CHM, follow these steps:

1. Remove the long axis belt (see Figure 6 on page 6).
2. Remove the screw from the strain relief (see Figure 1), the CHM cover (step A in Figure 2), and disconnect the grounding screw (step B in Figure 2) and CHM cable (step C in Figure 2).

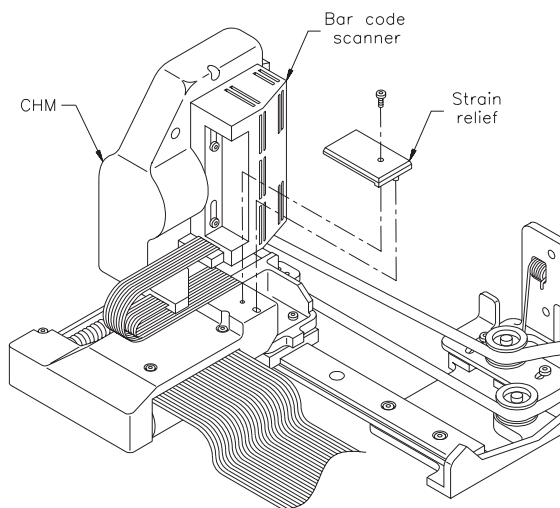

Figure 1 Removing the strain relief

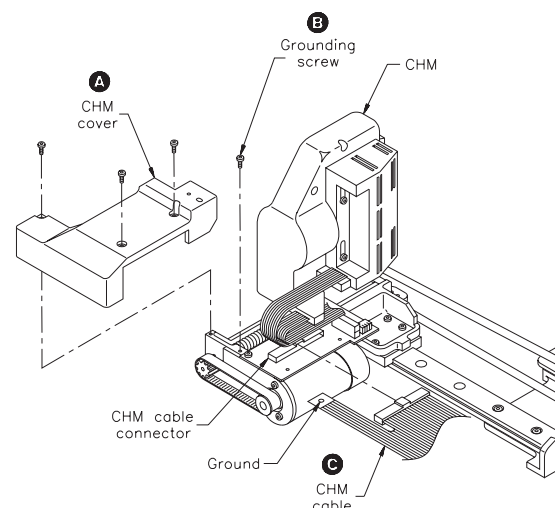

Figure 2 Removing the cover, cable, and cable ground

3. Remove the four screws that secure the CHM to the linear way block.
4. Remove the two screws from the long axis belt clamp, and remove the long axis belt from the CHM.

4 Removing the Bar Code Scanner (if necessary)

If your CHM has a bar code scanner, remove it. The replacement CHM does not include a bar code scanner. To remove the bar code scanner, disconnect the bar code scanner cable and remove the two screws that secure the bar code scanner to the CHM.

5 Installing the Bar Code Scanner on the New CHM

1. Use the locating pins on the back of the scanner to clip the scanner to the first and third holes on the CHM (see Figure 3).

Important

Do not use the bottom holes (the second and fourth holes).

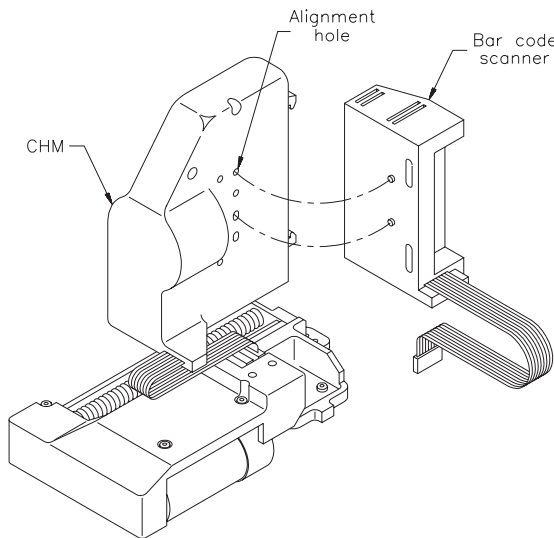

Figure 3 Attaching the bar code scanner to the CHM

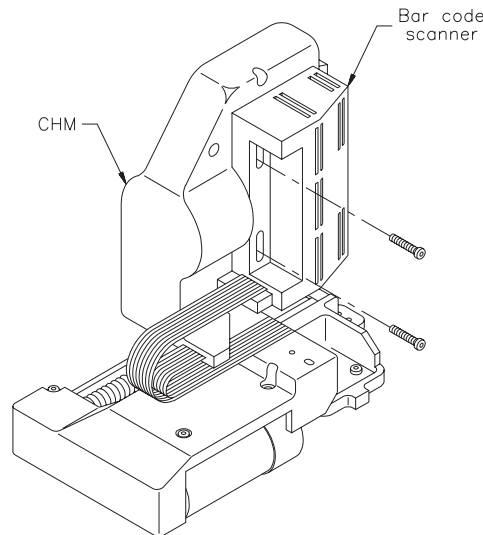

Figure 4 Replacing the bar code scanner screws

2. Replace the screws that attach the scanner to the CHM (see Figure 4). Make sure the screws are positioned at the bottom of each screw slot, as shown.
3. Reconnect the bar code scanner cable to the CHM. Make sure the cables are straight and neatly clamped to allow smooth flex motion.

6 Installing and Aligning the CHM

CAUTION

Use the alignment triangle when installing the CHM, otherwise the library will not operate properly.

Align the CHM while the library is placed horizontally on the workbench.

Make sure the CHM is not resting against either stop on the linear way; this causes incorrect tension on the belt.

1. Attach the long axis belt to the CHM, using two screws on the clamp.
2. Position the CHM mounting surface squarely on the linear way block (see Figure 5), and insert the four M3 \times 0.50 \times 6 mm screws. Tighten the screws, but leave them loose enough to allow alignment (see below). Do not tighten the screws to torque yet.
3. Locate the alignment triangle included with your replacement CHM. Place one side of the triangle in the linear way channel as shown in Figure 5. Push forward against the base of the CHM to align the base against the linear way block (see arrows in Figure 5). At the same time, push the triangle against the CHM base and adjust the CHM so there is no visible gap between the triangle and the CHM base (make sure the CHM cover is still off).

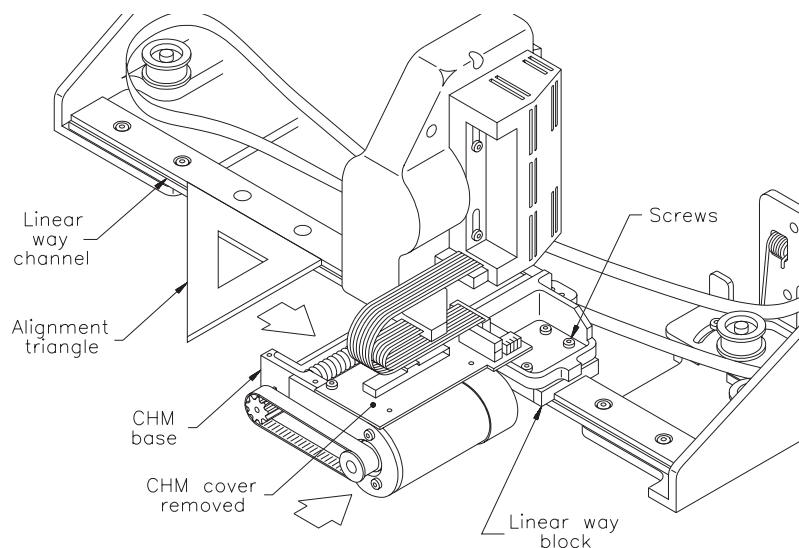

Figure 5 Using the alignment triangle to align the CHM

CAUTION

Make sure the CHM is aligned before you tighten the screws.

4. When you are certain that the CHM is aligned squarely on the linear way, use a T-10 TORX bit to tighten the four screws to 6.0 inch-pounds (6.9 kg-cm) of torque.
5. After you tighten the screws, use the alignment triangle to re-check the alignment.
6. Replace the long axis belt in the order shown in steps A , B , C , D , and E in Figure 6. Tighten the tension screws (step E) to 15.0 inch-pounds (17.2 kg-cm) of torque.

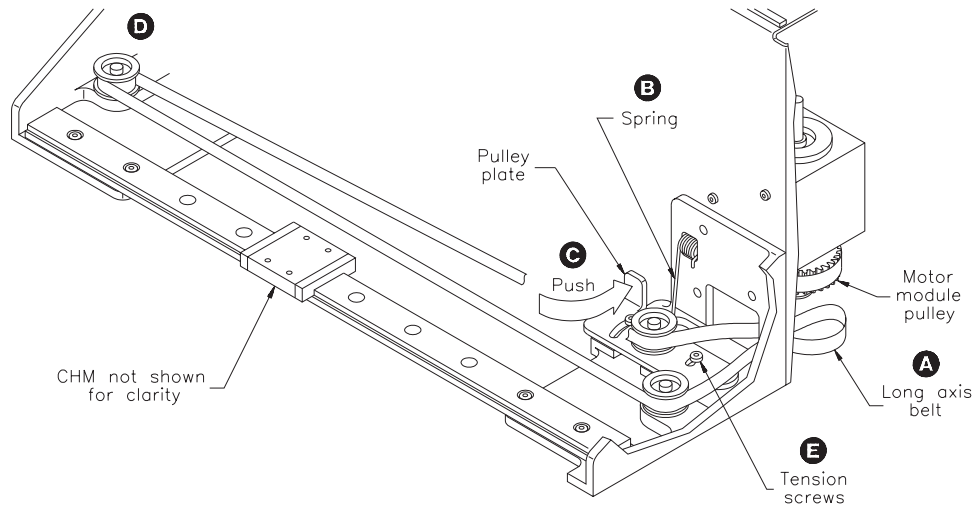

Figure 6 Removing and replacing the long axis belt

7. Connect the CHM cables and replace the cover and strain relief.